



# Best Practice NEW Drywall and Socket Detailing

## Installation Details

Set out in this section are Best Practice Solutions for the more common issues.

### Light Door Jamb

Suitable for doors weighing up to 25kg.

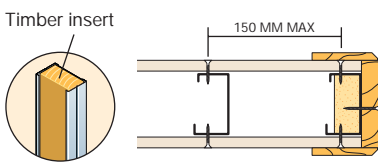

### Medium Weight Door Jamb

Suitable for doors weighing up to 50kg.

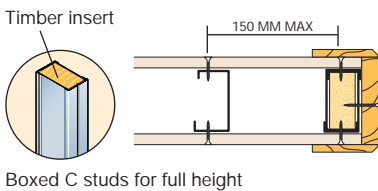

### Heavy Door Jamb

Suitable for doors weighing up to 75kg.

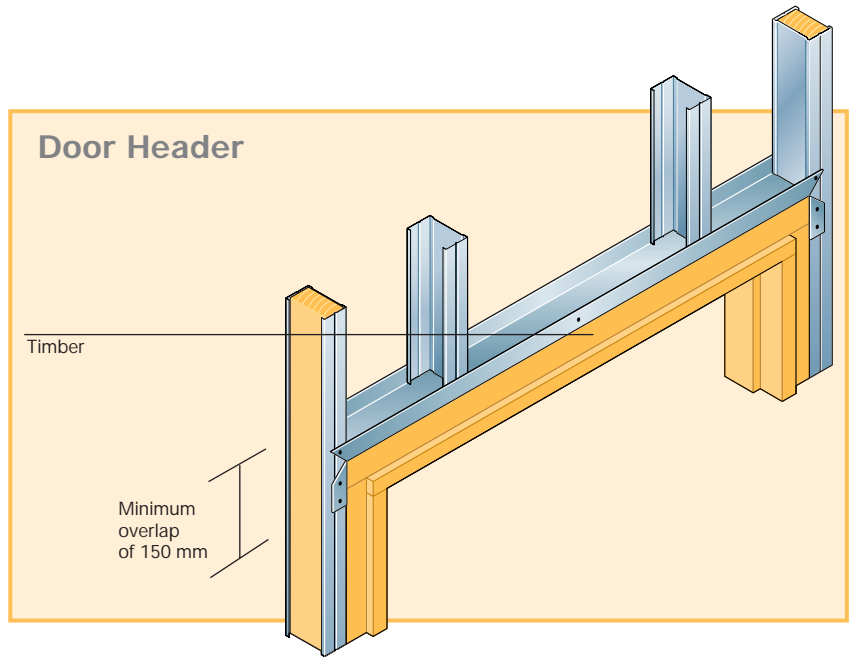
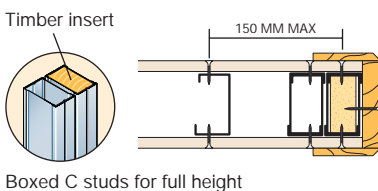

## Socket Detailing

The acoustic, intumescent putty pad is designed for lining electrical socket boxes in partition wall constructions. The mouldable putty pads easily fit socket boxes to reduce sound travel through partition walls, whilst providing flexibility when fitting avoiding accidental tearing or puncturing.

Cutting an electrical socket opening in a partition wall can reduce its acoustic performance and resistance to fire, which could therefore result in non-compliance with Part E and Part B Building Regulations.

**Speedline Putty Pads are the acoustically tested, intumescent solution, complying with Building Regulations Part E and Part B**

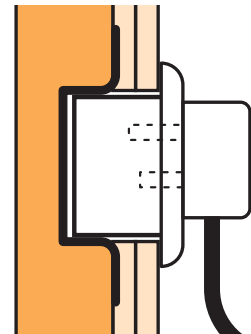
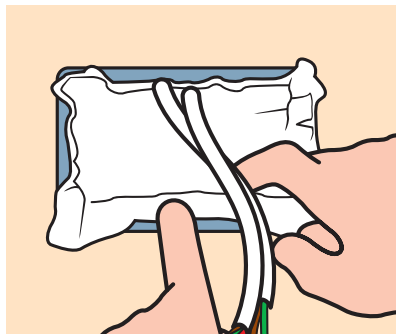

## Benefit

- Maintains acoustic integrity of the wall, with a rating of up to 69dB Rw
- Provides 2 hour fire resistance
- Complies with Building regulations Part E and Part B
- Easy to use and install
- Minimal waste
- Flexible - one size fits all
- Can be used with metal or plastic boxes
- Cost effective - labour and time saving
- Reduced damage on site and in transit