

Partitioning Systems **NEW**

Shaft Encasement System

A high performance fire protection system to enclose shafts in high rise buildings. The Shaft Encasement System allows installation to take place from the landing side only. This system is non load bearing and designed to fit between structural floors.

Benefits

- Fast and simple to erect
- Cost effective
- Good Impact resistance and stiffness
- Lighter in weight than masonry
- High level of Fire Protection
- Allows any thickness of coreboard to be used

Construction

The Shaft Encasement System is installed from the non shaft side using I Stud framing.

Fix Extra Deep (70mm leg) track to ceiling with suitable fixings spaced at 600mm maximum centres. Fix either standard or 32mm leg track along the floor with suitable fixings spaced at 600mm maximum centres. For 94mm and 148mm tracks we recommend two rows of staggered fixings at 600mm maximum centres.

Coreboard nominally 595mm wide by either 19mm or 25mm thick is cut to length 25mm less than the overall height for standard track and 32mm for 32mm leg track. The Coreboard is located between the I Studs and secured using shaft encasement brackets spaced at 600mm maximum centres.

The 25mm or 32mm gap is left at the top of the partition.

Fire Resistant plasterboard packers 100mm deep are screw fixed to the coreboard at the head of the partition. It is important that the

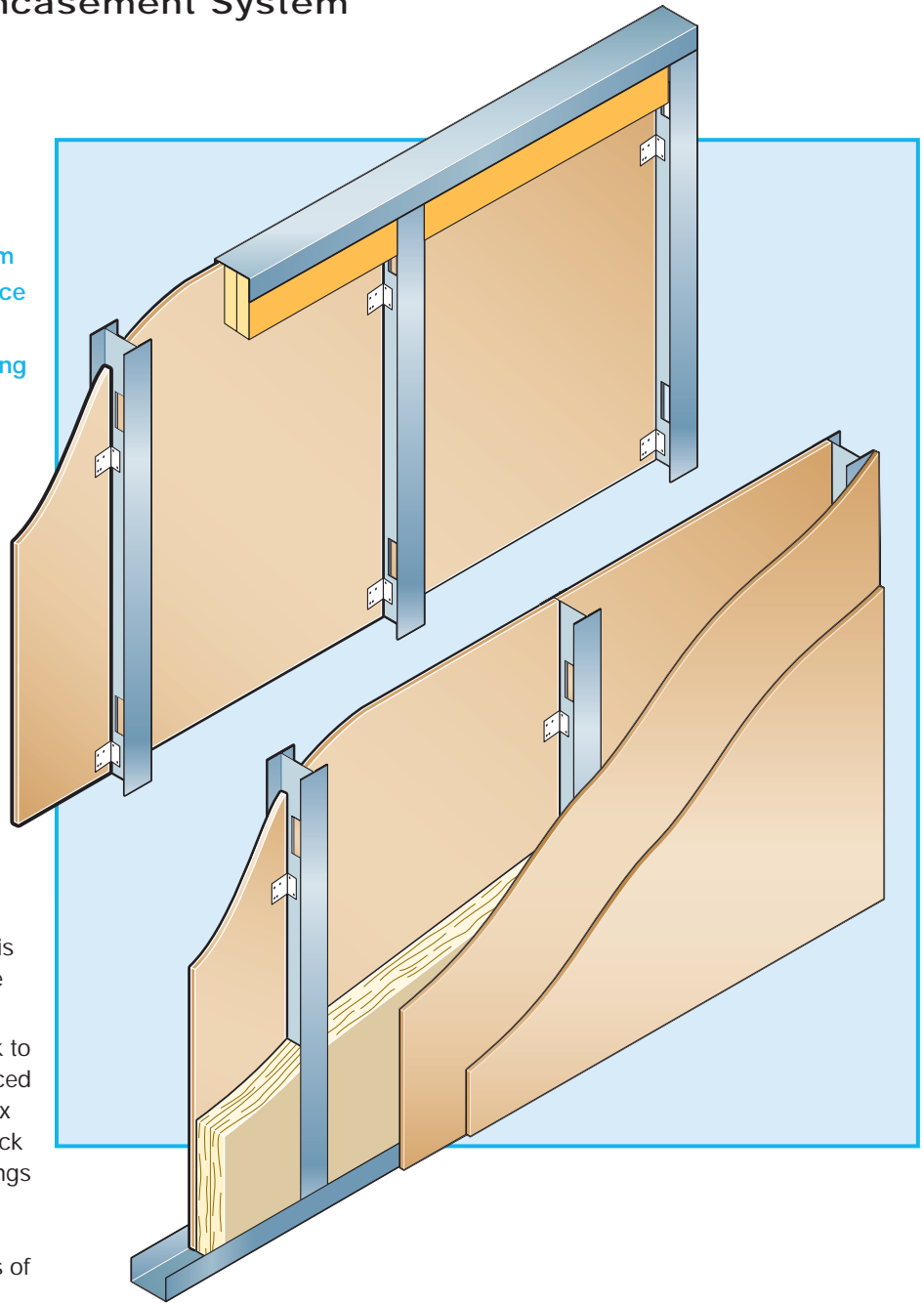

packers are tight against the head track and that the packers fill the full width of the track.

Intumescent acoustic sealant must be used :-

- On all metal to structure surfaces
- On all metal to Coreboard surfaces
- Between plasterboard packers and coreboard at the head detail.

Corner and Junction information is detailed separately.

Fire Resistant plasterboard is fixed to the outside of the framework on the non shaft side of the partition.

Single Layer Installations

Fire Resistant plasterboard must be fixed at 300mm maximum centres to the metal framework with the appropriate length screw.

Double Layer Installations

Inner layer of Fire Resistant plasterboard can be fixed at 600mm maximum centres but outer layer must be fixed at 300mm maximum centres to the metal framework with the appropriate screw. The second layer of Fire Resistant plasterboard should be fixed with all joints staggered in relation to the inner layer.

Partitioning Systems

Shaft Encasement System

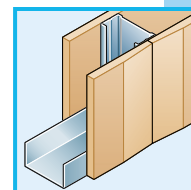

I Stud

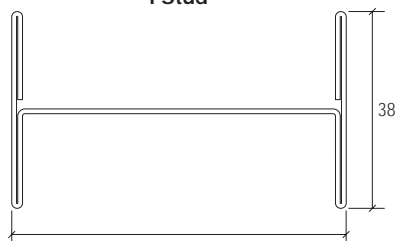

Available in 50, 60, 70, 92 or 146 wide

I Stud



Product Description	Stock Lengths Metre	Weight per Length Kgs
60mm I Stud x 0.6mm, Flange dimensions 38mm	3.600 4.200	2.82 3.30
70mm I Stud x 0.7mm, Flange dimensions 38mm	3.600 4.200	3.56 4.15
92mm I Stud x 0.9mm, Flange dimensions 38mm	3.600 5.000 6.000	4.59 6.37 7.65
146mm I Stud x 0.9mm, Flange dimensions 38mm	3.600 5.000 6.000	5.65 7.86 9.43

Standard Track

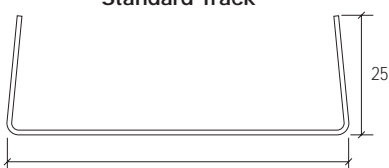

Available in 50, 52 or 72 wide

Track



Product Description	Stock Lengths Metre	Weight per Length Kgs
72mm Track (25mm leg) x 0.5mm	3.000	1.25
72mm Track (25mm leg) x 0.5mm	3.000	1.41

32mm Leg Track

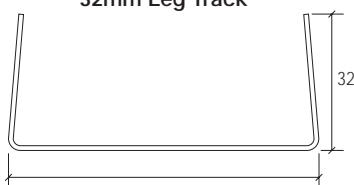

Available in 52, 72, 94 or 148 wide

Product Description	Stock Lengths Metre	Weight per Length Kgs
62mm Track (32mm leg) x 0.5mm	3.000	1.42
72mm Track (32mm leg) x 0.5mm	3.000	1.55
94mm Track (32mm leg) x 0.5mm	3.000	1.81
148mm Track (32mm leg) x 0.5mm	3.000	2.40

Deep Track

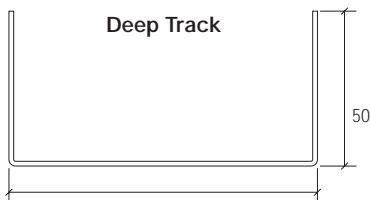

Available in 52, 62, 72, 94 or 148 wide

Product Description	Stock Lengths Metre	Weight per Length Kgs
62mm Deep Track (50mm leg) x 0.5mm	3.000	1.86
72mm Deep Track (50mm leg) x 0.5mm	3.000	1.98
94mm Deep Track (50mm leg) x 0.7mm	3.000	3.13
148mm Deep Track (50mm leg) x 0.5mm	3.000	2.83

Extra Deep Track

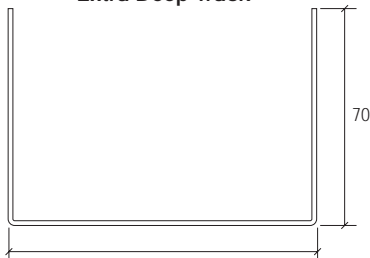

Available in 72, 94 or 148 wide

Product Description	Stock Lengths Metre	Weight per Length Kgs
72mm Extra Deep Track (70mm leg) x 0.7mm	3.000	3.43
94mm Extra Deep Track (70mm leg) x 0.7mm	3.000	3.79
148mm Extra Deep Track (70mm leg) x 0.7mm	3.000	4.68

Accessories

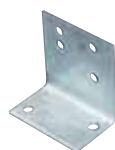

Product Description	Quality Per Box	Weight per Box Kgs
Shaft Encasement Fixing Bracket	1000	17.6

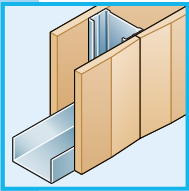

Partitioning Systems **NEW**

Shaft Encasement System

Coreboard nominally 595mm wide by either 19mm or 25mm thick is located between studs and secured using shaft encasement brackets spaced at 600mm maximum centres. Linings to the non shaft side of the partition as shown below.

60mm I Stud

Diagram Reference	Part Grade BS 5234	Max Height m	Nominal Weight Kg/m ²	Nominal Width mm	Fire Resistance mins	Sound Insulation No Infill Rw dB	Sound Insulation With Infill Rw dB	Single Layer		Double Layer		Test Reference
								12.5mm	15mm	12.5mm	15mm	
1	HD	4.2	30	75	60	34			FR			SE001
2	SD	4.4	39	85	90	37				FR		SE002
2	SD	4.5	41	90	120	41					FR	SE003
3	HD	4.2	31	75	60		41		FR			SE004
4	SD	4.4	40	85	90		44			FR		SE005
4	SD	4.5	42	90	120		45				FR	SE006

70mm I Stud

Diagram Reference	Part Grade BS 5234	Max Height m	Nominal Weight Kg/m ²	Nominal Width mm	Fire Resistance mins	Sound Insulation No Infill Rw dB	Sound Insulation With Infill Rw dB	Single Layer		Double Layer		Test Reference
								12.5mm	15mm	12.5mm	15mm	
1	HD	4.2	31	85	60	39			FR			SE007
2	SD	4.4	40	95	90	40				FR		SE008
2	SD	4.5	42	100	120	42					FR	SE009
3	HD	4.2	32	85	60		42		FR			SE010
4	SD	4.4	41	95	90		44			FR		SE011
4	SD	4.5	43	100	120		45				FR	SE012

92mm I Stud

Diagram Reference	Part Grade BS 5234	Max Height m	Nominal Weight Kg/m ²	Nominal Width mm	Fire Resistance mins	Sound Insulation No Infill Rw dB	Sound Insulation With Infill Rw dB	Single Layer		Double Layer		Test Reference
								12.5mm	15mm	12.5mm	15mm	
1	HD	6	32	107	60	40			FR			SE013
2	SD	6.4	41	117	90	42				FR		SE014
2	SD	6.7	43	122	120	43					FR	SE015
3	HD	6	33	107	60		43		FR			SE016
4	SD	6.4	42	117	90		46			FR		SE017
4	SD	6.7	44	122	120		46				FR	SE018

146mm I Stud

Diagram Reference	Part Grade BS 5234	Max Height m	Nominal Weight Kg/m ²	Nominal Width mm	Fire Resistance mins	Sound Insulation No Infill Rw dB	Sound Insulation With Infill Rw dB	Single Layer		Double Layer		Test Reference
								12.5mm	15mm	12.5mm	15mm	
1	HD	6.8	33	161	60	41			FR			SE019
2	SD	7.5	42	171	90	45				FR		SE020
2	SD	7.9	44	176	120	45					FR	SE021
3	HD	6.8	34	161	60		46		FR			SE022
4	SD	7.5	43	171	90		50			FR		SE023
4	SD	7.9	45	176	120		50				FR	SE024

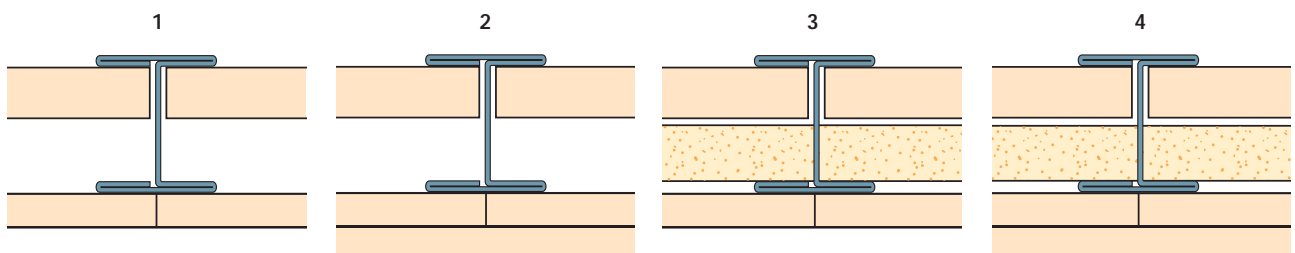

Partitioning Systems

Shaft Encasement System

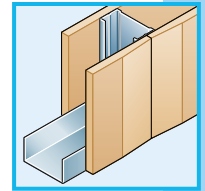

Inside corner

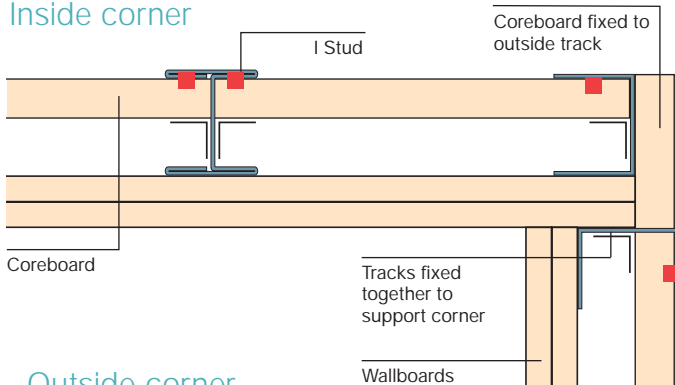

Wall junction, room side

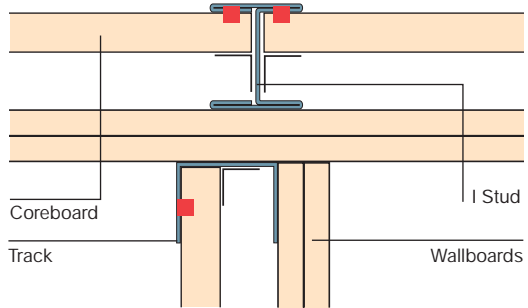

Outside corner

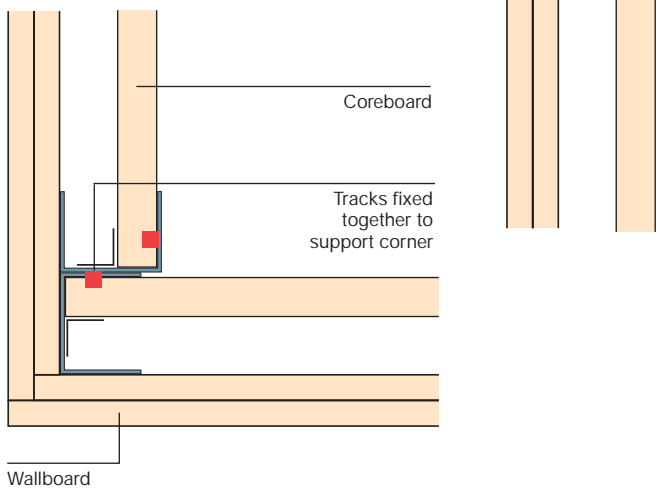

Wall junction, shaft side

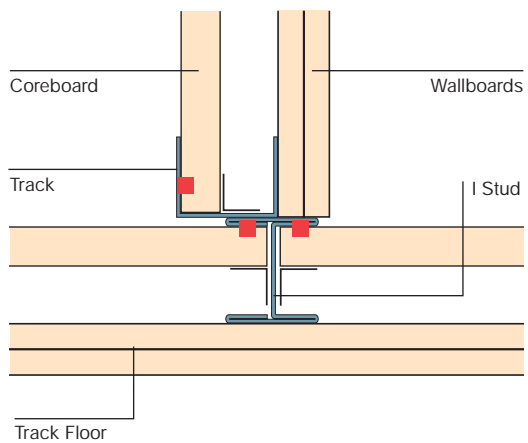

Start wall detail

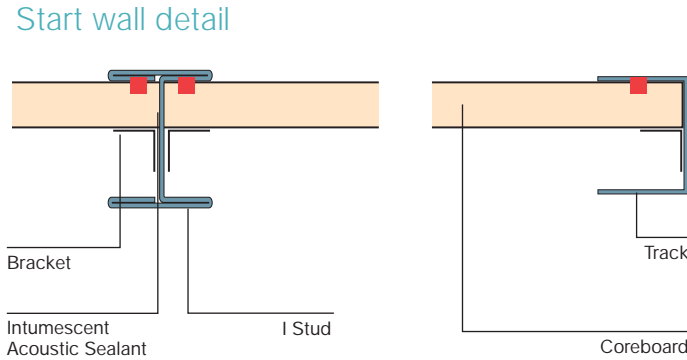

● Denotes 5mm Speedline Intumescent Acoustic Sealant

End wall detail

